

Antique Outboard Club News

Southern California Chapter

October 2019



All of us and our motors at Larry Fece's place; September 12th, 2019

Thank You Larry for the hospitality; We all enjoyed the "Eye-Candy" and Camaraderie!

Left to Right: Chuck Kober, John Van Dyke, Darryl Webber, Glenn Strobehn, Tom Lockwood, Bob Loll, Jake and Larry Fece, Steve, Mark Strikwerda, Kip Fjeld and friend Jean, Paul Brinkman, Frank Fowler, Jim and Karla Cohen. Oh, and MOO!



Bob Loll, Kip Fjeld and our Host Larry Fece form an impressive backdrop for one very sweet Mercury owned by Mike Strikwerda. On the Right.....Frank Fowler (right) welcomes potential member Jim Cohen and his wife Karla. Hope to see Jim and Karla again soon!



Darryl Webber and Tom Lockwood find a little shade and try to figure out how **Mark Strikwerda** managed to score so many cool motors. “Where did he get them” asks **Tom.....**” “Well.....he bought them, of course” answers **Darryl**. “But.....who would sell such fantastic motors” counters **Tom.....**And so it goes.....



Mark Strikwerda (Left) , Tom Lockwood and Mark’s Friend Steve (Right)



These four belong to new member **Mark Strikwerda!** Fabulous selection Mark!



Me thinks that this motor has seen some **ALKY** at some time in its past.....



Two Bendix Eclipse Outboards alongside a Johnson Opposed Twin



Jakes very own 15HP Aquasonic Evinrude. I have one too Jake; **LETS RACE!**



Larry has that awesome vehicle on that awesome lift-rack in his awesome garage. **Awesome!**



About as large as integrated tanks got before someone decided they needed to go remote,



The Raffle Sale: A fun activity that helps keep the dues low. Thanks Paul!



Lunchtime was blessed with some great food , a little shade and a welcome breeze!

Member Activities

Car Show in Carpinteria



Chapter Member **John Van Dyke** and Chapter President **Paul Brinkman** show up at the *Montecito Classic Car Show*.

John showed up in his 1930's *Graham Housecar*; built by his Grandfather.

Paul had to drag John away from the steady stream of visitors stopping by to ask about the car which draws attention everywhere it goes. Spotless in appearance and in great running condition with original engine and drivetrain.

John himself spent many years restoring the Graham to an unbelievable state of perfection. No Trailer Queen.....the *Housecar* was **DRIVEN** to the show.....and back!

The Northern California Chapter had a Meet...with Visitors!



Nor-Cal member **Wayne Seeburg** readies his *Mercury* for a run.

Nor Cal member **Bob Meyers** at the helm with his magnificent *Evinrude Speeditwin*.



Darryl Webber and **Chuck Kober** showed up at Salt Springs Valley Reservoir in Copperopolis California to swap spark plugs and other general paraphernalia with the NOR-CAL Boys! A great bunch of guys surrounded by an enviable assortment of lakes and rivers. It was a gorgeous day.....perfect 70's type sunny weather.....Motors were running, boats were skimming along on their chines.....Outboards were getting bought and sold out of car trunks and pick-up beds. AND....there was a great lunch of Chili and Cornbread. Yum! But don't worry **George Kent**.....you still hold the "BEST CHILI EVER" Award.

Mystery Motor! What is it?



Some Hints Below

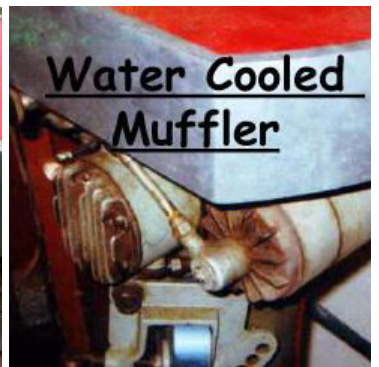

Can You Identify it? The Answer is on Page 8.

Christmas Show/Lunch is Scheduled:

Our annual Christmas meet has been tentatively scheduled for December 14th at 10 AM at Woody's Diner in Newport Beach. It's a two-part meet. First is a public display of our best motors at adjacent West Marine; always a fun event which brings a lot of attention to our Chapter and this great hobby. Then; Part Two....Christmas Lunch at 12 Noontraditionally free to paid-members in good standing. See you there!

The Art Form of Patent Drawings

May 23, 1939. D. R. CLARKE 2,159,256
 PORTABLE INTERNAL COMBUSTION ENGINE
 Filed Aug. 30, 1937 2 Sheets-Sheet 1

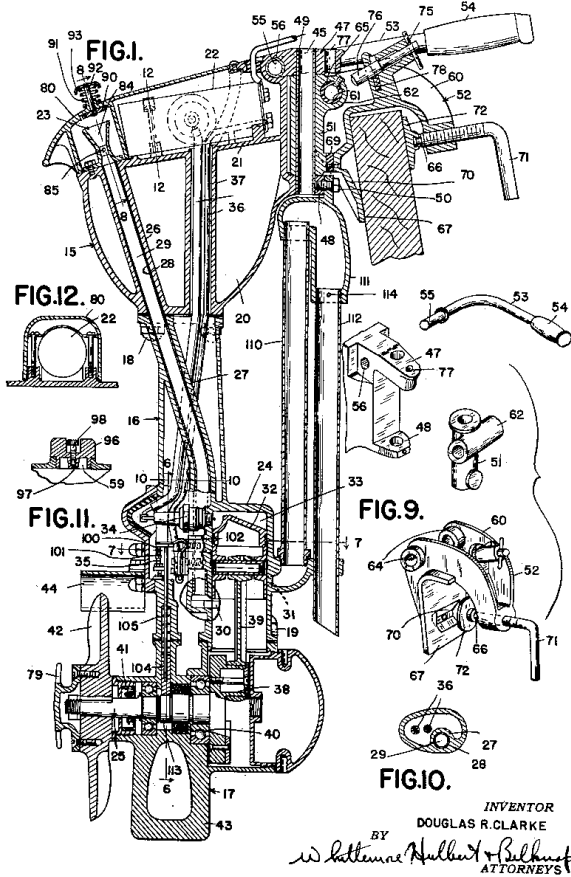

May 23, 1939. D. R. CLARKE 2,159,256
 PORTABLE INTERNAL COMBUSTION ENGINE
 Filed Aug. 30, 1937 2 Sheets-Sheet 2

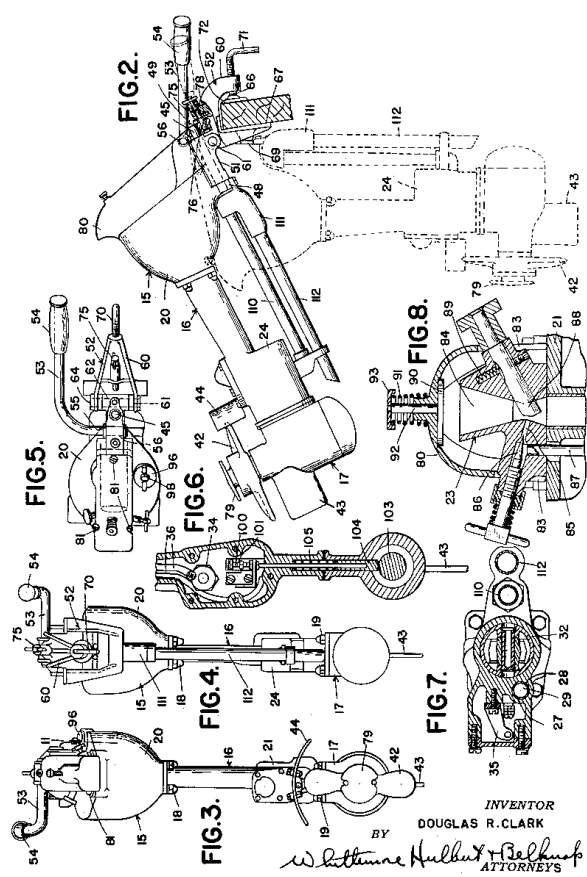

These are the Patent drawings for the 1939 **Clarke Troller**; a motor that some of us own and many others of us would like to own. Quite the curiosity everywhere they go! Patent drawings are beautiful in their complexity and perfection and they also serve to provide an x-ray view of sorts for most anything we come in contact with.

<https://patents.google.com/patent/US2159256A/en?q=d.r.clarke&oq=d.r.clarke>

AOMCI Elections are coming!

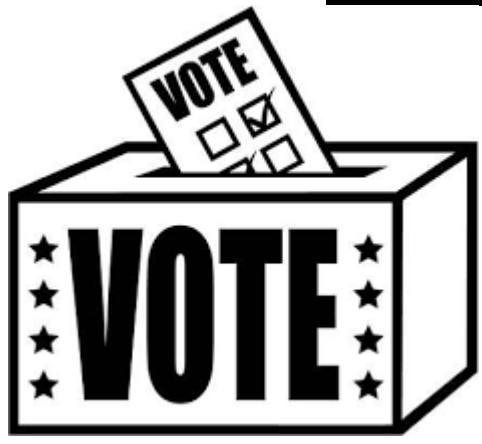

National and Chapter Elections are on the horizon. If you have not received your ballot from the Nationals...you should shortly. They were supposed to have been included in the October Issue of the *Antique Outboarder* but that did not happen for some reason so they are going to be mailed out under separate cover. Watch your Mailbox! There is still time to contact the candidates and talk over what they have in mind for the Club's future.

In addition...Chapter President **Paul Brinkman** has mentioned that our Chapter will discuss elections at our meet in March 2020. So if you have had hankerings to step up to the plate and bring your energy and enthusiasm to the Southern California Chapter....you will have your chance.



Buy/Sell/Trade Section

WANT TO SELL/TRADE

| | | |
|---|--|--|
|  | <p>Elto Model 314 30HP Fully Restored both Mechanically and Cosmetically</p> <p>Ready to run.</p> | <p>Make Offer Contact Darryl Webber 714-815-1663 Leave Message</p> |
|  | <p>Mercury KB-1A</p> <p>A rare old Mercury</p> <p>Acquired in 2019 from an out of-state Member</p> | <p>\$250.00 Contact Paul Brinkman Or Tom Lockwood</p> |
|  | <p>Built in Culver City! 1947 Master Cub Thought to be the first variant followed by Milburn Cub, Wego, Water Master and Commandco</p> | <p>Contact Doug Penn douglas.penn@gmail.com</p> |
|  | <p>1937 Johnson Model 110 1.7 HP</p> <p>Factory Rebuild in the 50's Up-Dated Re-Paint</p> | <p>Contact Doug Penn douglas.penn@gmail.com</p> |
|  | <p>1949 Mercury KF-5 Good Looking and even better running Mercury. Pumps Water fine; ready for the lake</p> | <p>\$150.00 to Club Members</p> <p>Contact Chuck Kober cwwk@cox.net</p> |

SUBMIT NOW FOR ENTRY INTO THE NEXT ISSUE!

WANTED TO BUY/TRADE

| | | |
|---|--|---|
|  | <p>West Bend 18HP "Shark"</p> <p>Any Condition Considered Elgin or other variants OK</p> | <p>Cash Paid; Tell me what you have.</p> <p>Contact Chuck Kober cwwk@cox.net</p> |
|  | <p>A Nice Rowboat Motor. I've always wanted one. Top priorities are Complete and Accurate; Un-restored Preferred. Running or not</p> | <p>Cash Paid. Tell me what you have. Ugly is ok but not TOO Ugly Contact Chuck Kober cwwk@cox.net</p> |



John Van Dyke sporting an AOMCI "Tomahawk Nationals 2019" Hat.....

Stylin' there John!



New Member Mike Strikwerda is a great chef! Thanks Mike so much for all the hard work on a hot hot afternoon. Great Lunch!

Answer to the Mystery Motor Quiz:



1928 Amphion Model 5A

Any Amphion is rare....but this one is the rarest of them all. Perhaps only ONE (1!) was ever built. When this motor was acquired by an AOMCI member in the 1960's.....it was in pieces and needed significant machining and tweaking to run. But; run it did! Amphion is mostly known for their early 20's Vertical Twin "Rowboat Motor Style" motors but this one is "Different": The 1928 Amphion Model 5A; essentially a prototype; it is a horizontally opposed twin thought to be appx 5-6 HP. Look at the "Hint" pictures; the air intake is also the mixture needle valve handle with a built-in spring loaded primer feature. Ignition is supplied by an American Bosch flywheel

magneto. The Muffler is water-cooled but the cylinder heads are not. The engine pictured featured ball bearings for the crankshaft and mains and lower unit; unusual for the day.

The Company was started in 1915 when owner Clarence J. Allen decided to convert his in-line vertical twin inboard motor to an outboard mounting. In the mid-20's A.J. Machek took over the company.

Information Courtesy of Arlan Carter, Peter Hunn, W.J. Webb, Phillip Kranz and Mark Wright.

The Antique Outboard Motor Club Inc. Membership Application

It's up to you to pull that first starter rope, fill out and mail this application or visit www.aomci.org to join today!

Date: _____
 Subscriber's Name: _____
 Spouse & Children: _____
 Address: _____
 City: _____ State or Province: _____
 Zip+4: _____ Telephone: _____
 Email: _____
 Website: _____

**Please Join the National Club
See Tom Lockwood**

American Postal Addresses

- 1 year membership (new and renewals): \$40.00
- 2 year biannual dues (new and renewals): \$70.00

Canadian Postal Addresses (US Dollars)

- 1 year membership (new and renewals): \$49.00
- 2 year membership (new and renewals): \$85.00

Other International Postal Addresses (US Dollars)

- 1 year introductory membership: \$52.00
- 2 year membership (new and renewals) - \$90.00



Mail this application and payment to:

AOMCI Membership Services
PO Box 909
Barberton, OH 44203

The AOMCI is a registered non-profit hobby organization dedicated to the preservation and restoration of old outboards. Please allow 4-6 weeks for our volunteers to process your request.

This form can be downloaded at
<https://aomci.org/wp-content/uploads/2019/09/New-Membership-Application-AOMCI-19.pdf>